

FIRE-PROOF DOORS

Buy our door kits or even become a FLEMA installer by buying our components in bulk.

In both cases, take advantage of our CEN1363-1 and CEN 1364-1 certification.

To obtain our catalogue and manufacturing program, do not hesitate to contact our Customer Service:
e-mail : info@flema.be

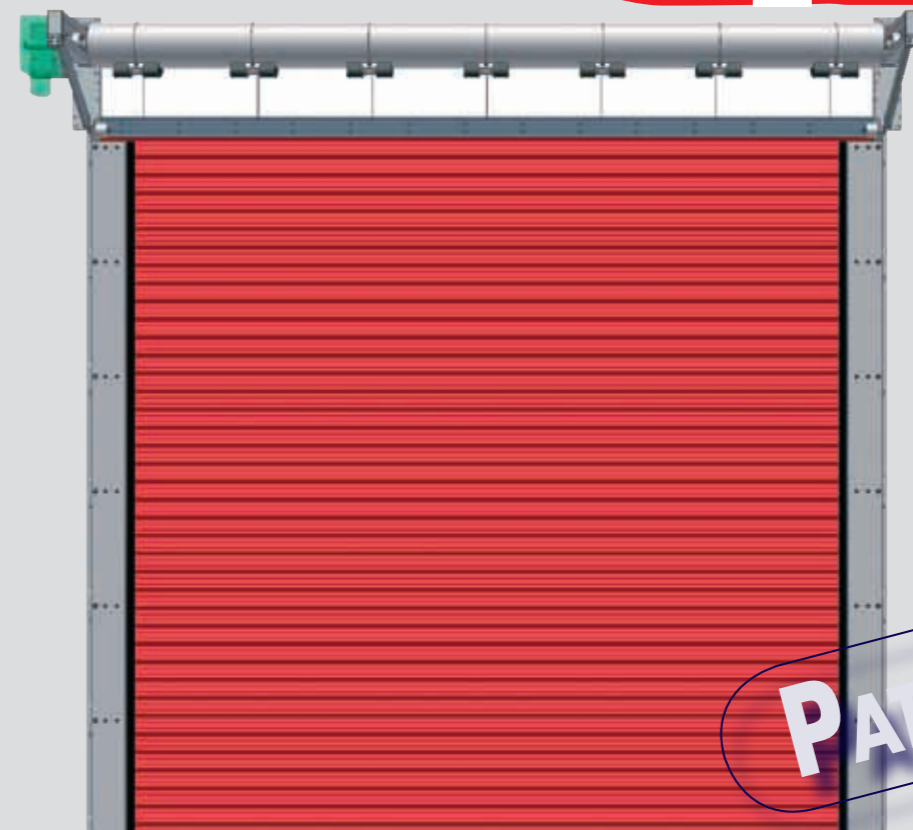
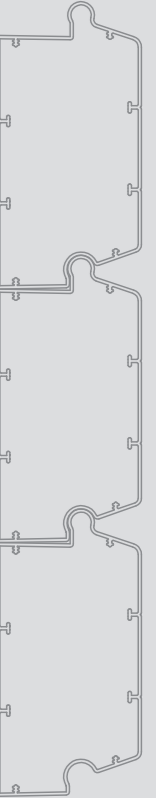

FLEMA sprl
rue Outre 46
7910 Anvaing
Belgium
T : +32(0)69/67.27.87
F : +32(0)69/67.27.80
www.flema.be

www.flema.be

Roller shutter **VR60**
Fire resistance : 60'
Inside installation



Today, thanks to a high level of technicality of our products, the fire-proof doors are lighter and close to traditional doors.

Flema was established in 2004 with the purpose of developing fire-proof products (roller shutters, sectional and sliding doors) of a design very close to traditional closing elements in order to achieve light, modern and easy to produce, assemble and install doors at very competitive prices.

To achieve this challenge, we have filed a patent. The concept is quite simple: synthetic profiles with an intumescent core.

Mission accomplished!

Roller shutter VR60

The fire resistance is obtained thanks to its patented RF60 plate and frame.

The mechanical system is close to that of a traditional door.

The Flema roller shutter is made up of:

- 1 - a RF60 frame
- 2 - a RF60 plate
- 3 - track profiles
- 4 - a rolling system
- 5 - a motorised system



slats
thickness : 36 mm
weight : 30 kg/m²

 Patented Flema

frame
18 x 120 mm

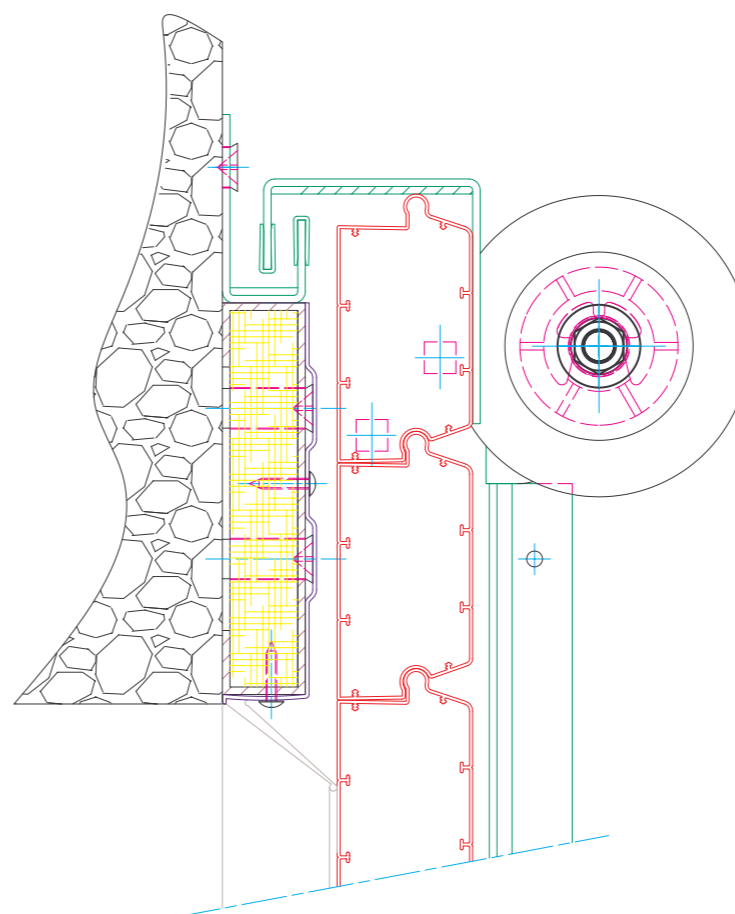

The track profiles are set onto the frame and are produced in two parts to limit the transmission of temperatures. They are made up of a U-shaped profile needed for the tracking of the blade in which a PVC profile is slipped into to be used as a finishing and airtight and watertight profile.

The drive pulley (159 mm in diameter) moves on 2 universal support bearings to enable a perfect rolling movement and without stress on the plate.

The Flema fire door is operated by a powerful motor (three-phase/380 volts) in connection with dependable worm gear drives. In the case of fire, an additional 24V motor, powered by a low-voltage emergency supply facility, ensures that the door closes properly.

Given the very simple design, this roller shutter carries many advantages:

- a patented system
- synthetic matter: rustproof
- mass tinted
- close to a traditional shutter
- easy to install
- very light mechanism and plate
- air and water tightness
- reduced obstruction
- motorisation MFZ of new generation
- approved by the food processing and medical industries

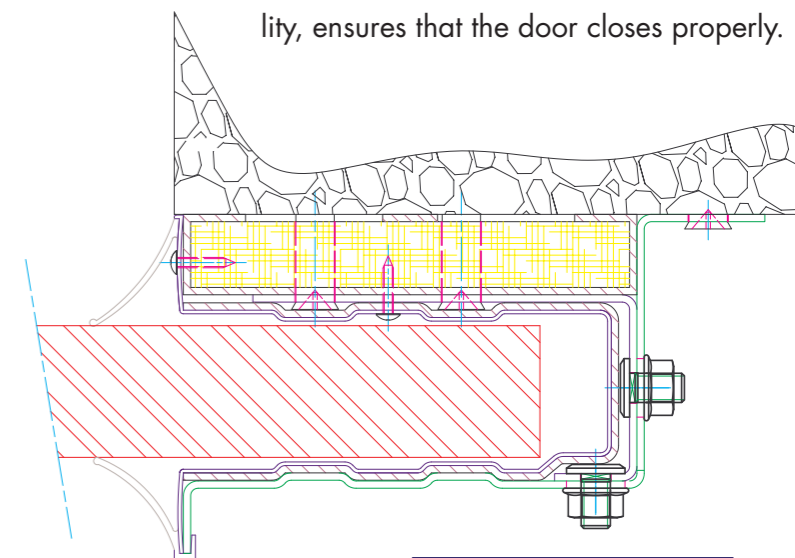

Certified products
This roller shutter has already been tested and approved as per the CEN1363-1 and the CEN1364-1 European standards soon in application

