



Catalogue

Sectional door
PS60

Inside installation

Today thanks to a high level of technicality of our products, the fire-proof doors are lighter and close to traditional doors.

Flema was established in 2004 with the purpose of developing fire-proof products (roller shutters, sectional and sliding doors) of a design very close to traditional closing elements in order to achieve light, modern and easy to produce, assemble and install doors at very competitive prices.

To achieve this challenge, we have filed a patent. The concept is quite simple : synthetic profiles with an intumescent core.

Mission accomplished !

1. Plate	6
2. Accessories for the plate	7
3. Flexi-Force hardware	9
4. Frame profiles	13
5. Motorisation and accessories	14



The sectional door **PS60** has been approved as per the CEN1363-1 and the 1634-1 European standards.

Our prices are :

- ex-works
- excluding VAT
- Gross price without discount
- in euro

Delivery time :

- 4 weeks for the kits
- 3 weeks for the components in bulk

Legend

	
Weight	Quantity per box

 **patent pending**

Sectional Door **PS60**

Fire resistance : 60'

The Flema **PS60** sectional door is a fire-proof door characterised by its panel and by its frame in synthetic matter. The whole set was developed around a standard hardware of the Flexi-Force type. Making it a door that is similar to the traditional door presently found on the closure market.

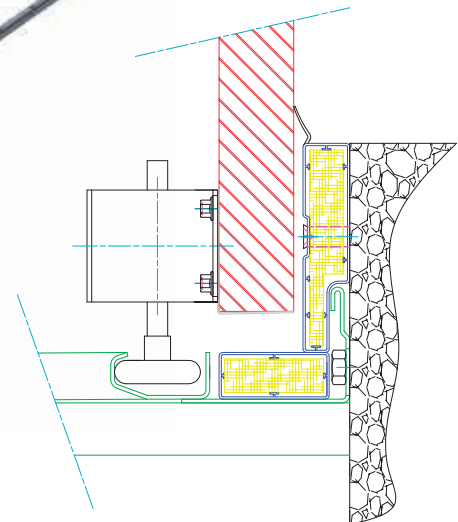
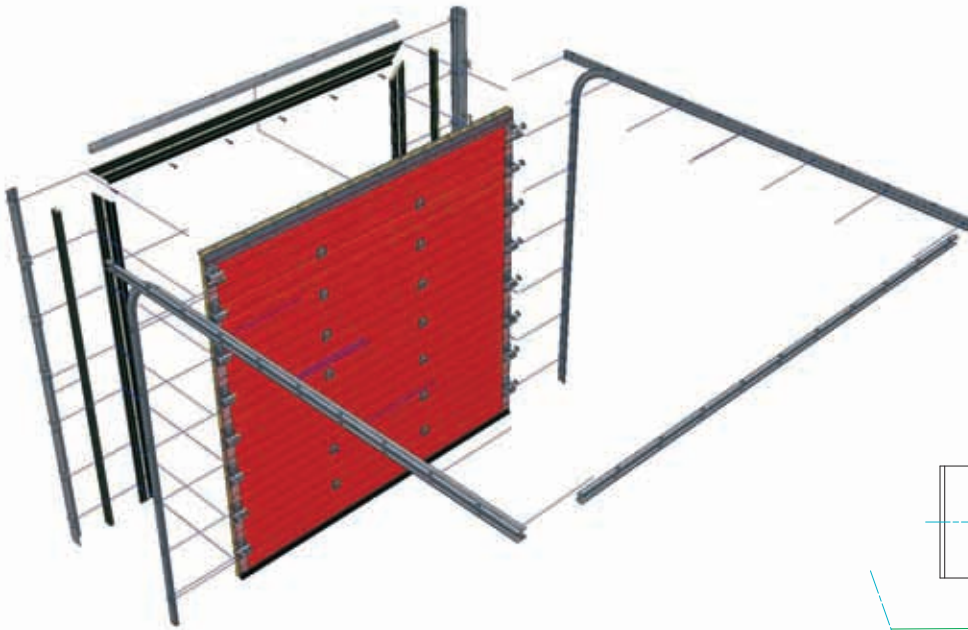

This door has many advantages :

- patent pending
- thickness of panel : 40mm
- synthetic matter : rustproof
- mass tinted
- easy to install
- conventional Flexi-Force mechanism
- air and water tightness
- reduced obstruction
- electrical motor
- approved by the food processing and medical industries
- RF60, EI60, EW60

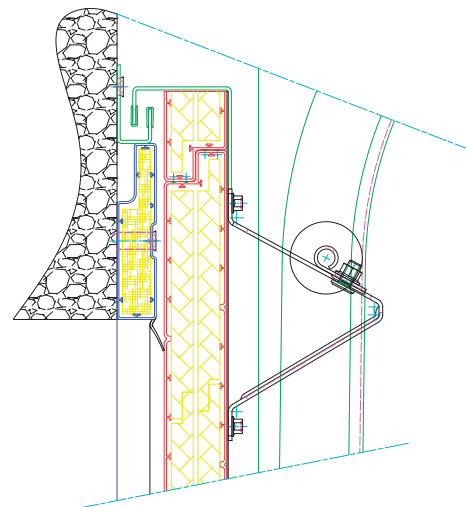

Sectional door **PS60**

Opening preparation details

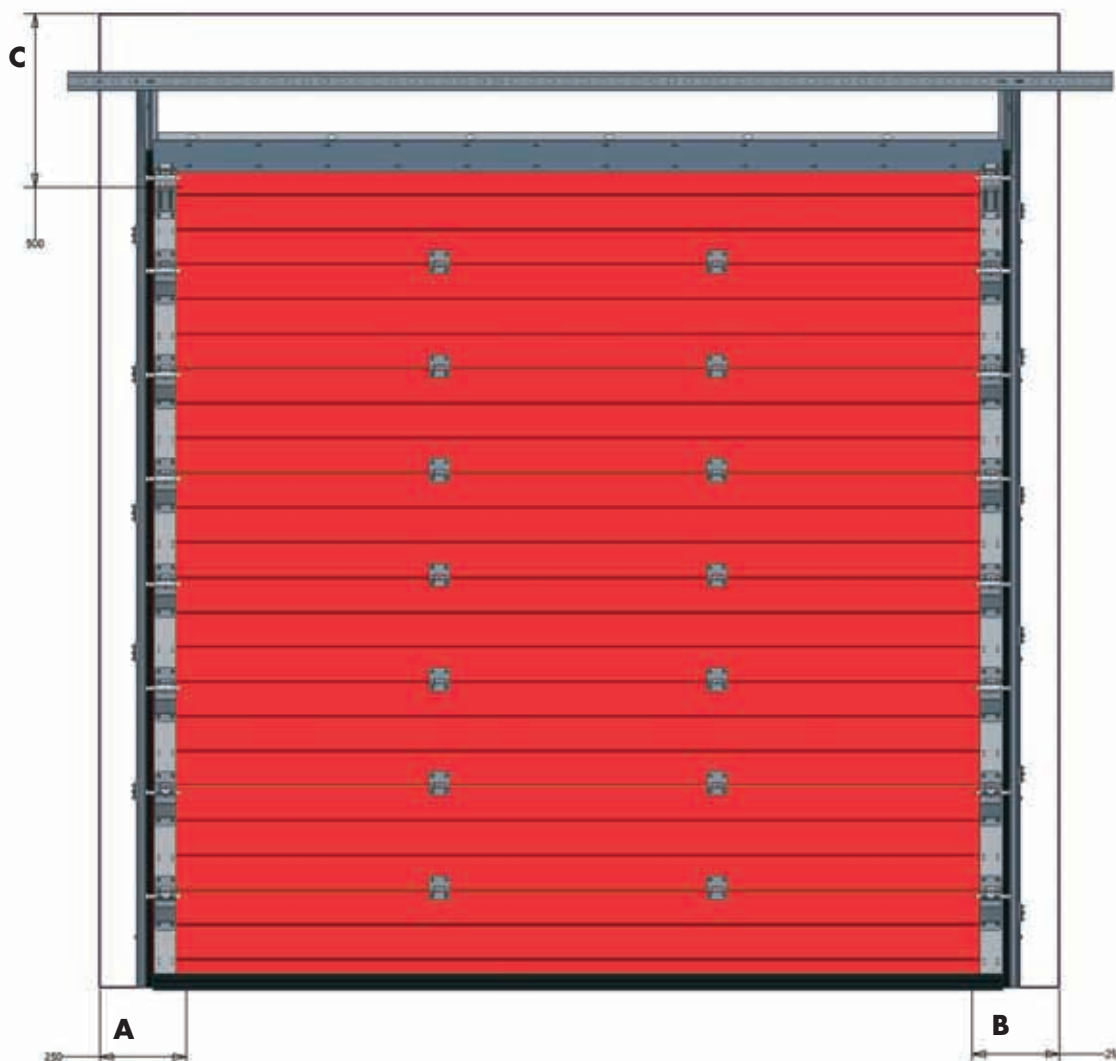

A = standard Flexi-Force + 75

B = standard Flexi-Force + 75

C = standard Flexi-Force + 115

All the information regarding
the opening preparation details
are on our Internet site :
www.flema.be



The door plate of the sectional door consists of synthetic panels with an intumescent core.

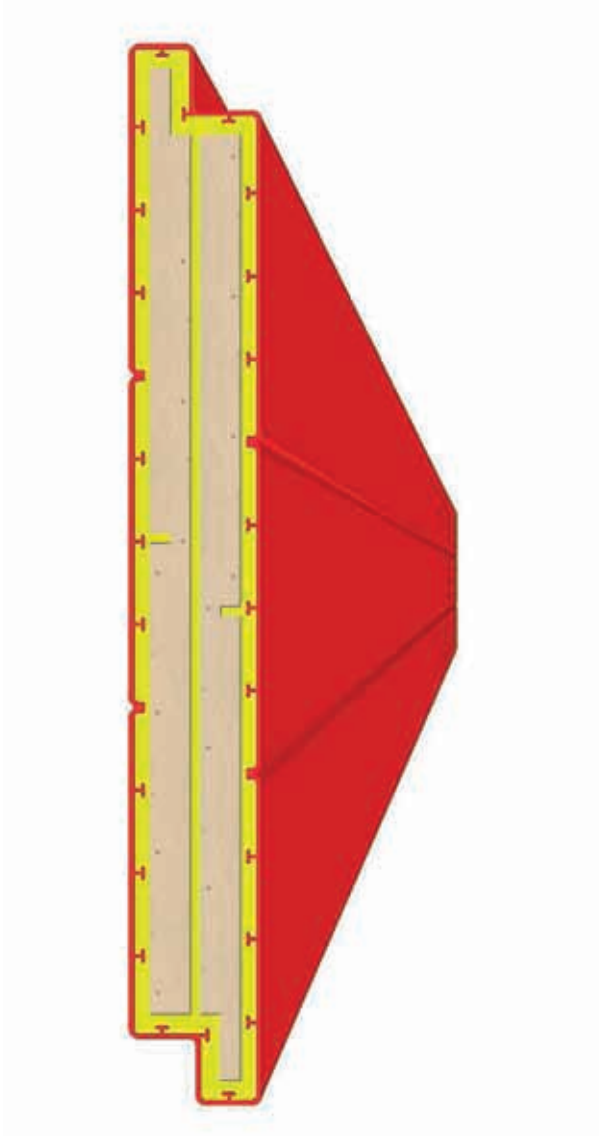

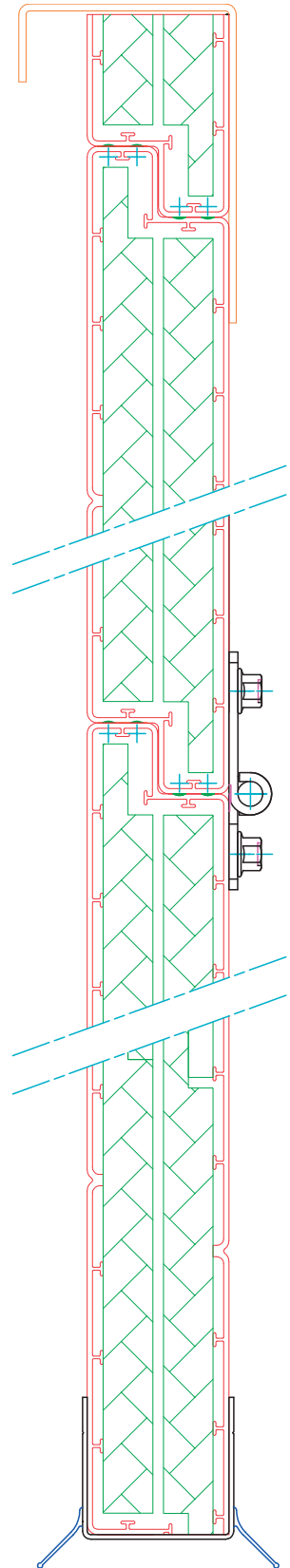

- thickness : 40mm
- width : 300mm
- weight : 38kg/m²
- mass tinted
- synthetic matter
- colours available :
 - red
 - grey



Red panel RF60



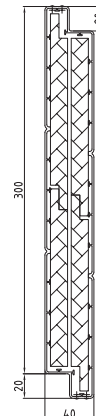

Ref.	Description	Unit		
3101	Lg 3200mm	pc	38kg/m2	18
3102	Lg 4200mm	pc	38kg/m2	18
3103	Lg 5200mm	pc	38kg/m2	18
3104	Lg 6200mm	pc	38kg/m2	18

synthetic matter
red colour



Grey panel RF60



Ref.	Description	Unit		
3151	Lg 3200mm	pc	38kg/m2	18
3152	Lg 4200mm	pc	38kg/m2	18
3153	Lg 5200mm	pc	38kg/m2	18
3154	Lg 6200mm	pc	38kg/m2	18

synthetic matter
grey colour

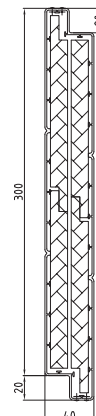

Bottom seal



Ref.	Description	Unit	EN	
2151	Lg 3200mm	pc	0.96	10
2152	Lg 4200mm	pc	1.26	10
2153	Lg 5200mm	pc	1.56	10

co-extruded profile in synthetic matter 40x40
PVC profile used as bottom seal

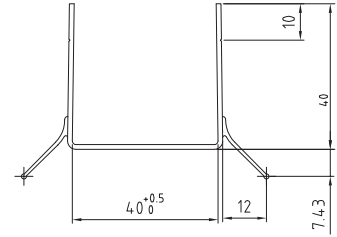

PVC profile 40x40



Ref.	Description	Unit	EN	
2181	Lg 3200mm	pc	0.86	50
2182	Lg 4200mm	pc	1.14	50

profile in synthetic matter 40x40
PVC profile used as top seal

Panel horizontal angle

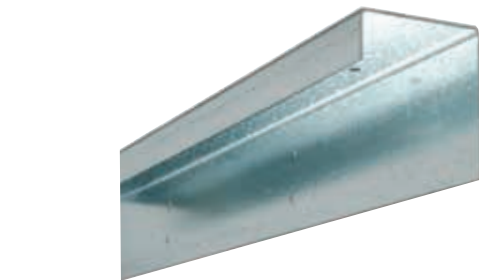

Ref.	Description	Unit	EN	
6252	Lg 3000mm	pc	7.56	60

profile in steel thickness 2mm
placed on the top of the plate
is used for keeping the door closed
in case of fire

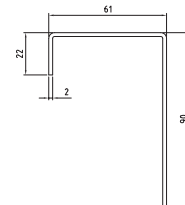

Perlau



Ref.	Description	Unit	EN	
7010	20mm /2mm	mt	0.048	400
7011	40mm /2mm	mt	0.092	200

Perlau 20mm/2mm
placed in the s-profile of the wall

Perlau 40mm/2mm
placed in the bottom seal and the top s-profile

FLEXIFORCE HARDWARE



Introduction

The Flema fire overhead door system, is developed in close co-operation with Flexi-Force®. The product range of Flexi-Force® hardware components for overhead doors can fully be integrated in a Flema fire door.

Flexi-Force Group B.V. is an entirely independent Dutch company with subsidiary companies in the Netherlands (Barneveld), Hungary (Hajdúböszörmény), Spain (Oliva) and China (Wuxi). These establishments are characterized by their regional distribution and sales function, in combination with in-house facilities for the manufacture of torsion springs, steel profiles, curves and complete hardware sets. The combination of its own manufacturing facilities together with a reliable and proven suppliers' network are the basis for Flexi-Force® to offer a maximum support to her customers.

With Flexi-Force® hardware and the Flema panels, you can install a fire overhead door almost exactly the way that you install all other overhead doors. This concept has been tested and certified according to the fire resistant norms CEN 1363/1 and CEN 1634/1 at the accredited institute Warringtonfiregent in Gent.

The certificate is valid when you use Flema products in combination with Flexi-Force® hardware only.

Adding the Flema panels to the Flexi-Force ITTR on EN13241-1 is planned for 2006.

Configuration

Flexi-Force® offers a configured-to-order hardware set (panel code C3501), in which all mandatory components are integrated. The configuration of this set provides in solutions for the higher door weight per m², the maximum door weight of 750kg and special component solutions. So an easy way of ensuring that you get the proper parts for your Flema door.

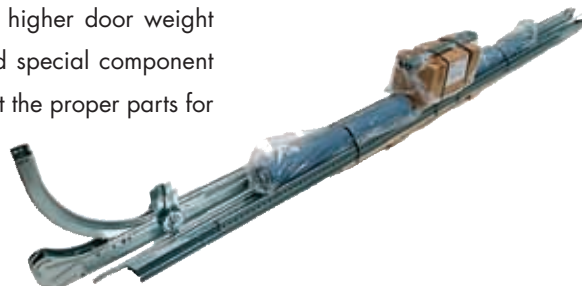

HARDWARE



For building a Flema hardware set yourself, according to the certificate, the following items are mandatory. Take into account that there are different rules in the configuration compared to a standard overhead door, such as :

- plate weight 38kg/m²
- wedge distance at the bottom of the door is bigger
- tracks must be riveted or bolted to the angle
- no screws, locks or grips can be used that go through the panel.
- build-in height and width are different
- special components needed.

Cable break device





Ref.	Description	Unit		
440-600	Cable break device			

Not-adjustable, 11mm roller, 2" tracks, 750kg

Cable break device



Ref.	Description	Unit		
440-3"	Cable break device			

Not-adjustable, heavy version, 11mm roller, 3" tracks, 750kg

Intermediate hinge



Ref.	Description	Unit		
450HZ+10	intermediate hinge			

10mm raised top blade

Side hinge



Ref.	Description	Unit		
450CZ+10	side hinge			

adjustable, 10mm raised top blade, complete, 11mm roller

Roller



Ref.	Description	Unit		
571	Roller			
572	Roller			
579	Roller			

571 roller, galvanised steel, 2" , shaft 11mm, L= 193mm, 45kg

572 roller, galvanised steel, 2" , shaft 11mm, L= 118mm, 45kg

579 roller, galvanised steel, 3" , shaft 11mm, L= 193mm, 68kg

Top roller bracket



Ref.	Description	Unit	KG	
415CZ	Top roller bracket			

Galvanised, adjustable, complete, 11mm roller

Clip

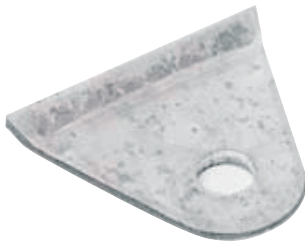

Ref.	Description	Unit	KG	
1046	Clip			

Galvanised, 3.0mm, for struts 65S and 110S

End cap L-shape



Ref.	Description	Unit	KG	
38E290F	End cap L-shape			
38ED290F	End cap L-shape double			

Flema, L=290mm



All other components can be selected from the standard Flexi-Force® product range. Contact your Flexi-Force sales team for more information or detailed instructions on the Flema configuration. Contact details on: www.flexiforce.com/company/sales.

Fire-proof profile of frame

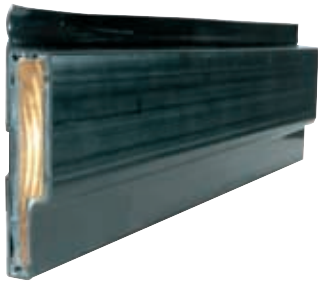

Ref.	Description	Unit		
2481	Lg 3250mm	pc	1.04	30
2482	Lg 4250mm	pc	1.37	30
2483	Lg 5250mm	pc	1.69	30

profile in synthetic matter allows the fire, water and air resistance is placed around the opening

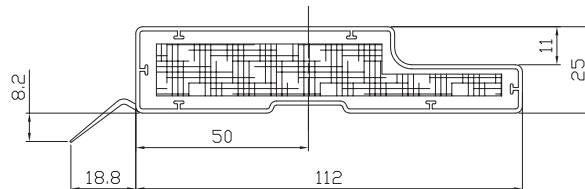

fire-proof profile of angle



Ref.	Description	Unit		
2471	Lg 3200mm	pc	1.87	20
2472	Lg 4200mm	pc	2.46	20
2473	Lg 5200mm	pc	3.05	20

profile in synthetic matter placed in the angle allows the fire resistance

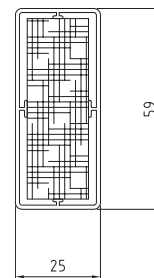

Horizontal angle of lintel



Ref.	Description	Unit		
6201	Lg 3000mm	pc	3.3	60

profile in galvanised steel 2mm is placed on the top of the frame allows the maintain of the plate against the frame in case of fire

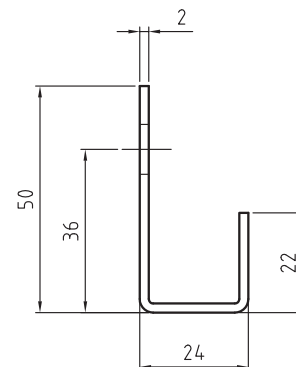

Electrical motor MFZ



Ref.	Description	Unit		
4591	electrical motor	pc		1

Under normal conditions, the Flema fire door is operated by a 0.55kw motor (three-phase/400volts) in connection with dependable worm gear drives.

In the case of fire, an additional 24V motor, powered by a low-voltage emergency supply facility, ensures that the door closes properly. The drive motor and controls form a single unit and have been approved together with the door system.

The system is available as a roller shutter drive and as a drive for sectional doors.

ASO13 Card

Ref.	Description	Unit		
4520	ASO13 Card	pc	x	1

For automatic control

Bottom edge safety device



Ref.	Description	Unit		
4550	safety device	pc		1

Mobile photoelectric barrier made up of :
 - a pair of unit 4 cells
 - a box of connection.

Allows to ensure the safety of an automatic door. CE tested with a maximum speed of movement of 320mm/sec.

Hydraulic motorisation



Ref.	Description	Unit	REM	
4592	cyindre 1250mm	pc		1
4592	cylinder 1250mm	pc		1
4593	cylinder 1500mm	pc		1
4594	cylinder 1750mm	pc		1
4595	cylinder 2000mm	pc		1
4596	cylinder 2250mm	pc		1
4597	cylinder 2500mm	pc		1
4598	cylinder 2750mm	pc		1
4599	cylinder 3000mm	pc		1

- constitued of :
- 1 jack
 - 1 power station
 - 1 box
 - 1 pipe

Equipped with a system with low tension which guarantees the good closing of the door.



pulleys system

Ref.	Description	Unit	REM	
4700	pulleys system	set (4)		1

Pulleys set for hydraulic motorisation

- constitued of :
- 1 mobile pulley
 - 2 mural pulleys
 - 1 attach for the cable.

Is appropriate for doors going up to 850 kg.



FLEMA sprl

rue Outre 46

7910 Anvaing

Belgium

T : +32(0)69/67.27.87

F : +32(0)69/67.27.80

TVA : BE 865.121.323

Bank: Fortis : 001 444 613 724

